

Touch-Up Requirements

Maibec CanExel™ Siding Read this before applying

It is best practice to apply touch-up paint to all cut and to all bare siding, in order to fully protect the siding against water and rot. It is necessary to do all the touch-up for horizontal cuts and strongly recommended for vertical cuts, even if a sealant or moulding will be applied after installation.

1. Storage

Winter: Touch-up paint must always be kept at room temperature (max 38°C/100°F).

Summer: Keep out of direct sunlight.

2. Tools

Use polyester, nylon, or any synthetic applicator with firm bristles approved for water-based coatings.

3. Paint Preparation

Stir for at least 1 minute using a wooden spatula, making certain to scrape the sides and the bottom of the can until it is homogeneously blended. This should be repeated a couple of times (at least every 2 hours or as needed) over the course of a day's work.

4. Application

For maximum adherence, visible touch-ups should be done at temperatures above 10°C/50°F. Do not apply touch-up paint to wet siding or trim.

- To touch-up small areas such as nail heads or scratches, use an applicator no larger than the intended surface. Carefully dab the area.
- Apply touch-up paint to all cut surfaces and to all bare siding, even if it is not visible once the siding is installed. It is easier to touch-up boards before they are installed.
- All exposed face nails must be properly sealed in a manner that prevents moisture intrusion and water buildup.
- Do not use wide brushes that could cause drips and give poor results.

"TOUCH-UP PAINT" IS ONLY MEANT TO BE USED IN THE AREA IN NEED OF IT. IT MUST NOT, UNDER ANY CIRCUMSTANCE, BE APPLIED OVER NON-DAMAGED FACTORY COATED MATERIAL. DIFFERENCES IN TONE DUE TO THE MISAPPLICATION OF TOUCH-UP PAINT WILL NOT ALWAYS APPEAR IMMEDIATELY, EMERGING ONLY AFTER REPEATED ULTRAVIOLET EXPOSURE.

MAIBEC® IS NOT LIABLE FOR ANY VARIATION IN COLOR DUE TO THE INCORRECT APPLICATION OF TOUCH-UP PAINT. MAIBEC® WILL NOT BE LIABLE FOR ANY VARIATIONS IN SHEEN OR TONE AND FOR CHALKING.

Touch-up paint

ILLUSTRATION 1

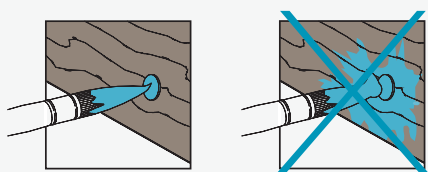

ILLUSTRATION 2

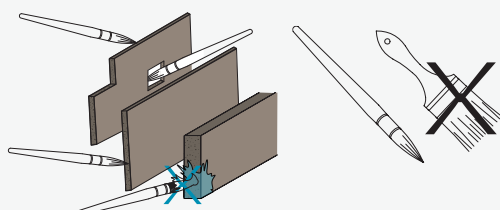





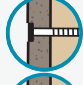
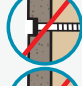
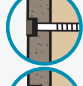



ILLUSTRATION 3

CONDITION		CORRECTION : INVISIBLE NAILS	VISIBLE NAILS
 SNUG	»	 OK	PAINT
 FLUSH	»	 OK	PAINT
 VISIBLE FIBER	»	 PAINT	PAINT
 COUNTERSUNK 1/16" - 1/8"	»	 APPLY SEALANT.	APPLY SEALANT AND PAINT.
 COUNTERSUNK MORE THAN 1/8"	»	 APPLY SEALANT. RE-NAIL	APPLY SEALANT AND PAINT. RE-NAIL